

Mounting instructions

 **Eclettis**[®]
SHAPES OF ELEGANCE

INSTALLATION BOXES SL1001 - SL1011

INSTALLATION BOXES SL1001 - SL1011

Components and installation:

Standard backbox	SL1001
Standard counterframe	SL1301
Standard counterframe for covering	SL1302
Standard frame	SL1201
Slim backbox	SL1011
Slim counterframe	SL1311
Slim frame	SL1211

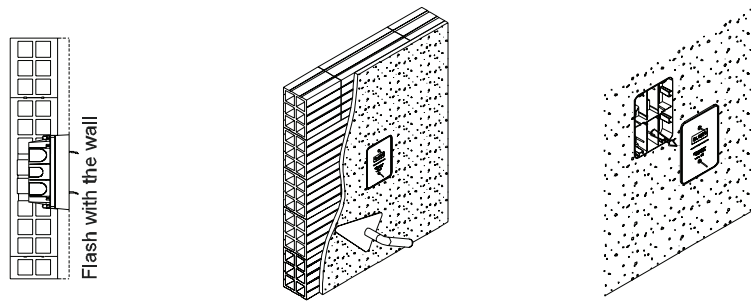

Prepare the excavation so that the back box and the template can be fitted flush with the plaster, without being leaning.

Plastering the wall. The plaster should be aligned with the template previously laid.

Remove the lid of the template.

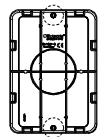
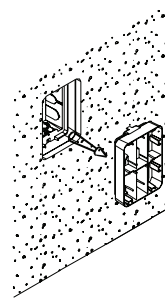
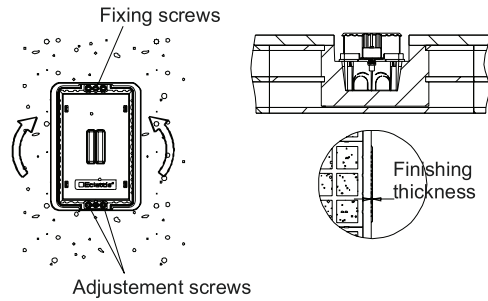
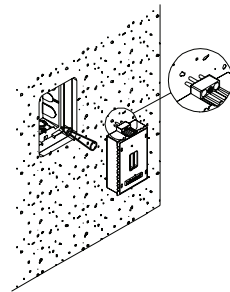

Fig. A

Remove the two screws (fig. A) and remove the template from the wall.



In the space left by template put the frame. CAUTION: Before installation tighten the side screws at full stroke.



Adjust the counterframe so that it is perfectly levelled and leave stick out the outer border of the last finishing thickness (2 mm approx.) When the counterframe is in the perfect position, fix it with the two central screws.

INSTALLATION BOXES SL1001 - SL1011

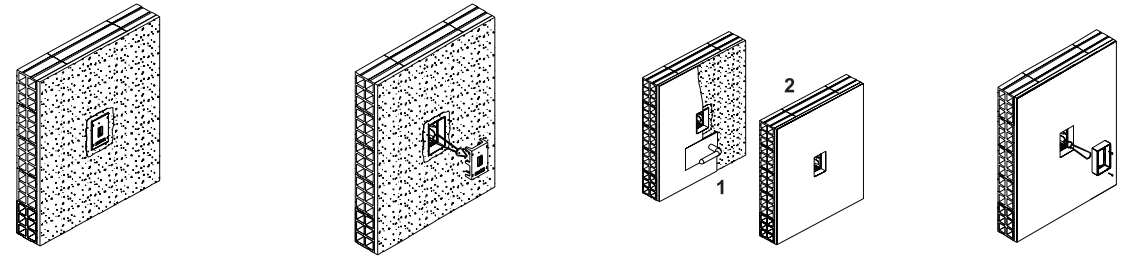

Fill the space around the counterframe with the same material for the plaster, leaving out the edge of the frame.

After the filing will be completely hardened, remove the support of the frame.

Complete the wall finishes flush with the counterframe. The edge of the counterframe must remain visible (1). Paint to cover up the edge of the counter, taking care to clean up the inside from any drips or residues (2).

When the work is finished, put the frame and fasten it with two screws taking care not to exceed the max torque of 0.4 Nm, in order not to deform the product.

INSTALLATION ON COVERINGS

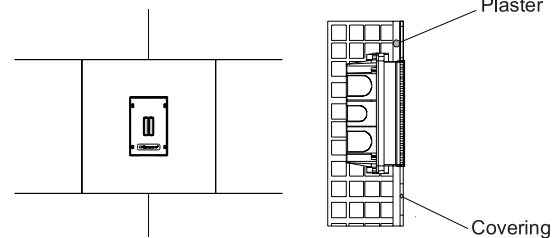

Follow the same instructions above reported, by using the appropriate counterframe SL1302. In this case the outer border of the counterframe will remain flush with the exposed surface of the covering (the counterframe will protrude from the plaster for the thickness of the covering).

INSTALLATION OF COUPLED BOXES

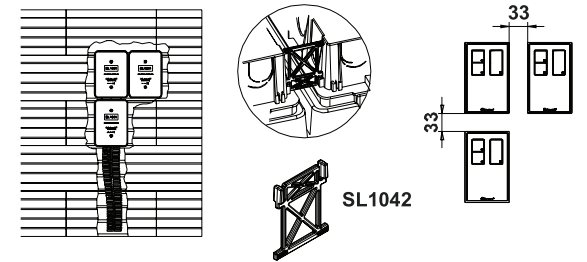

In order up more boxes together, use the accessory SL1042. The distance between a plate and the other one will be 33 mm.

.....

.....

.....

.....

.....

.....

BACK BOXES FOR PLASTERBOARD SL1031

INSTALLATION KIT SL1031

Components and installation SL1031:

- Box for plasterboard SL1031
- Frame for plasterboard SL2201 (to be ordered separately)

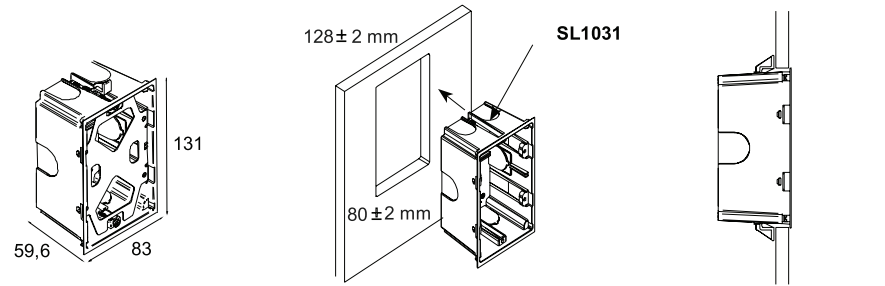

View and dimensions of box SL1031 with central steel plate.

Place the box into the hole (128x80mm) created on the plasterboard wall.

View in section of the embedded box.

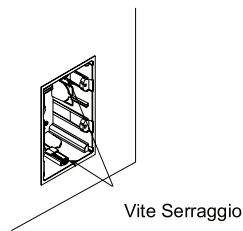

Fix the box through the fixing screws and extract the central steel plate.

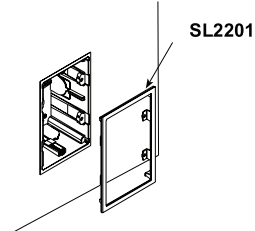

Fasten the frame SL2201 through the appropriate spaces.

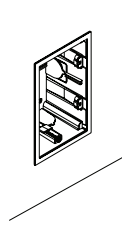

View of the frame. Proceed with the installation of the supports, commands and plates.

.....

.....

.....

INSTALLATION KIT SL1032

Components and installation KIT SL1032:

- Clamp ST0000
- Embedding box without its template

ST0000 bending points:

- 1 Standard 15mm
- 2 Standard 25mm
- 3 Slim su 15mm
- 4 Slim su 25mm

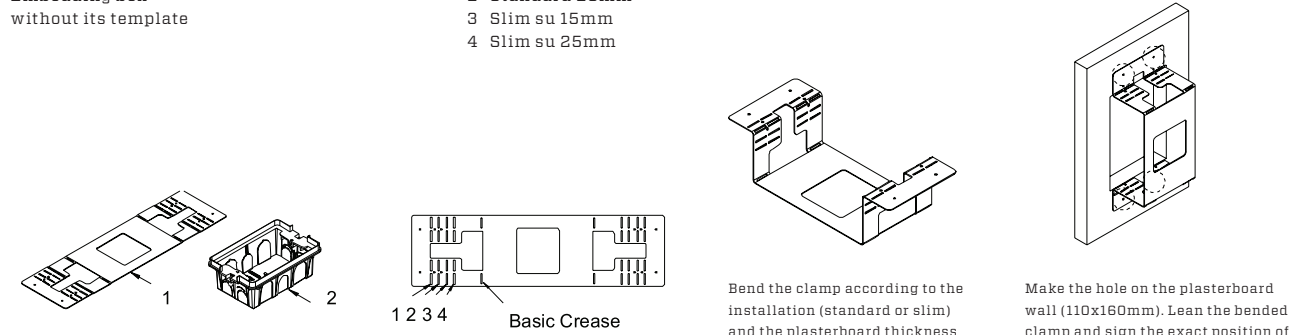

Bend the clamp according to the installation (standard or slim) and the plasterboard thickness (15/25mm).

Make the hole on the plasterboard wall (110x160mm). Lean the bended clamp and sign the exact position of the fixing holes on the wall.

INSTALLATION KIT SL1031

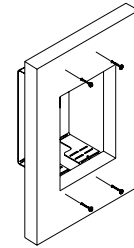

Insert the clamp into the hole and fix it head-on with countersunk self drilling screws. Screws have to be fixed on the position signed before.

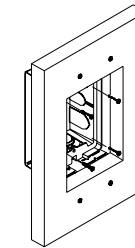

Place the box. Lean the bottom of the box on the clamp and fix it with n. 4 self drilling screws.

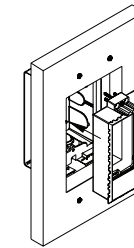

Insert the counter-frame (standard or slim); adjust its position and fix it with its screws.

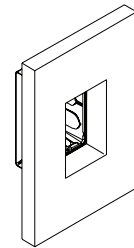

Fill the gap with construction material and fill up the wall.

.....





.....

.....

SINGLE ELECTRONIC COMMAND
Art. XR1000 - XR1001 - XR1002 - XR1003 - XR1011

SINGLE ELECTRONIC COMMAND

Functions selector (mode choice):

-  **A - SWITCH/TWO WAY SWITCH**
-  **B - PUSH BUTTON**
-  **C - LED FOLLOWING RELAY STATE**
(Art. XR1000 - XR1001 - XR1011)
-  **D - LED ALWAYS ON**
(Art. XR1000 - XR1001 - XR1011)

Front / Side Views - Dimensions (mm)

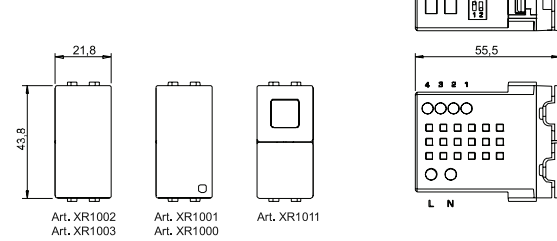

Configuration SWITCH with LED following the relay state (Function selectors: 1 ON - 2 ON)

A

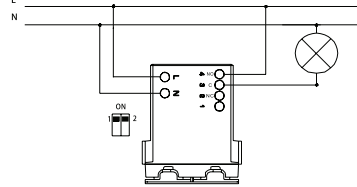

Configuration SWITCH with LED always ON (Function selector: 1 OFF - 2 ON)

B

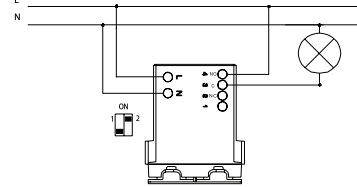

Configuration TWO WAY SWITCH with LED always ON (Function selector: 1 OFF - 2 ON)

C

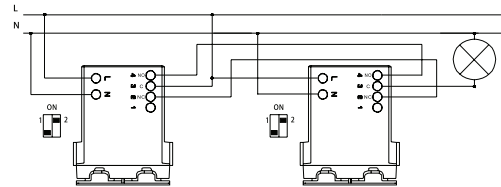

Configuration PUSH BUTTON with LED always ON (Function selector: 1 OFF - 2 OFF)

D

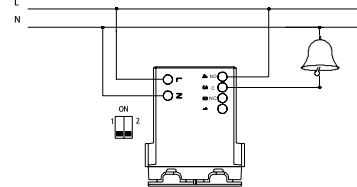

SINGLE ELECTRONIC COMMAND

Technical data :

- <> Rated Voltage: 110 - 240 Vac (50/60Hz)
- <> contacts: changeover relays (C - NC - NO)
- <> Possible loads at 240 Vac:

- > incandescent lamp: 1000 W max
- > iron core transformer for extra low-voltage incandescent lamps: 500 VA max
- > electronic step-down converter for extra low-voltage incandescent lamps: 350 W max
- > resistive load: 1000 W max

- <> the above figures refer to new relay whose contacts have not been overloaded even accidentally, such as to damage the surface of the contact pads
- <> relay configuration: push button, switch, two way switch (Programming has to be performed when power is off)

Options:

- <> memory state for power failure (Art. XR1001 - XR1002 - XR1011)
- <> without memory state (Art. XR1000 - XR1003).
When power is on again, the load is off. It has to be switched on manually.

Regulation:

- <> Directive BT
- <> Directive EMC
- <> Regulation EN 60669-2-1-2004

Installation requirements:

The managed load must be protected by a delay fuse with high breaking capacity and rated voltage max T6,3AH/250V

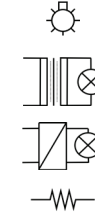

Installation advices:

The rated power should never be exceeded. For any other use not covered in This guide (es. Switching on from two or more points, higher power supply load Management, mixed systems) we recommend the combined use of remote-control or latching relays, without capacitors connected to the coil. In this case, the external device should be appropriate to the type of the electrical system.

Warnings:

- <> Store in a dry place at temperature between -5°C and +40°C.
- <> Handle with care. To be transported in a dry and dusty environment at a temperature between -5°C and +40°C
- <> Temperature range between -5°C and +40°C.
- <> Avoid direct exposure to heat and UV rays.
- <> Products from Smooth Line series are intended for indoor use responding to the above.
- <> The installation must be done by qualified personnel in accordance with equipment standards.

.....

.....

.....

.....





.....

.....

DOUBLE ELECTRONIC COMMAND
XR1101 - XR1102 - XR1103

DOUBLE ELECTRONIC COMMAND

Functions selector (mode choice):

-  **A - DOUBLE SWITCH**
(Led following relay state - Art. XR1101)
-  **B - DOUBLE SWITCH**
(Led always on - Art. XR1101)
-  **C - DOUBLE PUSH BUTTON N.C.**
(Led always on - Art. XR1101)
-  **D - DOUBLE PUSH BUTTON N.C.**
(Led always on - Art. XR1101)

Front / Side Views - Dimensions (mm)

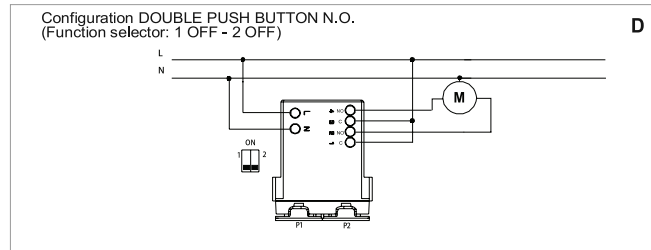
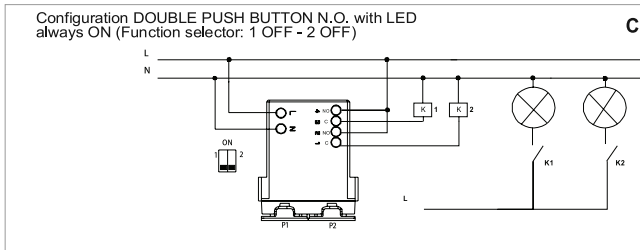
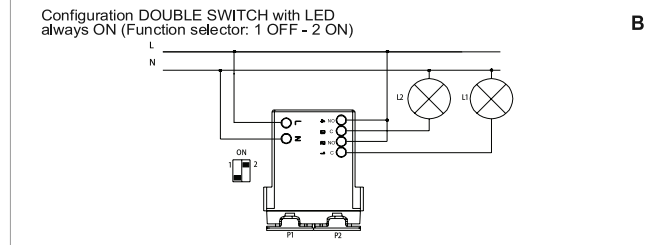
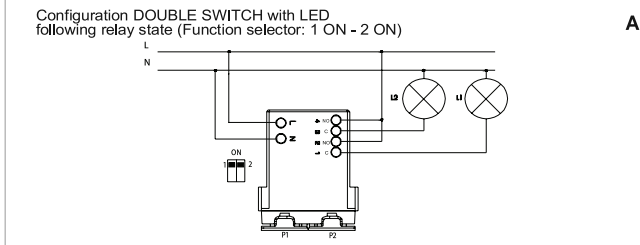
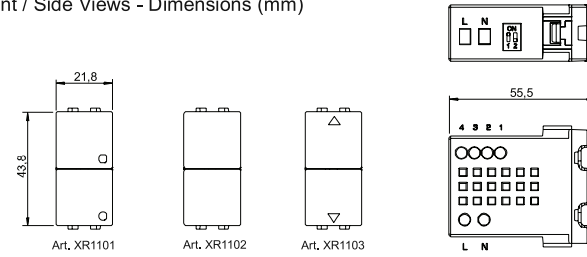

DOUBLE ELECTRONIC COMMAND

Technical data :

- <> Rated Voltage: 110 - 240 Vac (50/60Hz)
- <> contacts: n.2 relays (C - NO)
- <> Possible loads at 240 Vac:

- > incandescent lamp: 300 W + 300 W max
- > iron core transformer for extra low-voltage incandescent lamps: 300 VA + 300 VA max
- > electronic step-down converter for extra low-voltage incandescent lamps: 200 W + 200 W max
- > resistive load: 300 W + 300 W max
- > motor load: 1,2 A + 1,2 A max

- <> the above figures refer to new relay whose contacts have not been overloaded even accidentally, such as to damage the surface of the contact pads
- <> relay configuration: push button, switch, two way switch (Programming has to be performed when power is off)
- <> memory state for power failure

Regulation:

- <> Directive BT
- <> Directive EMC
- <> Regulation EN 60669-2-1-2004

Installation requirements:

The managed load must be protected by a delay fuse with high breaking capacity and rated voltage max T6,3AH/250V

Installation advices:

The rated power should never be exceeded. For any other use not covered in this guide (es. Switching on from two or more points, higher power supply load Management, mixed systems) we recommend the combined use of remote-control switch or latching relays, without capacitors connected to the coil. In this case, the external device should be appropriate to the type of the electrical system.



Warnings:

- <> Store in a dry place at temperature between -5°C and +40°C.
- <> Handle with care. To be transported in a dry and dusty environment at a temperature between -5°C and +40°C
- <> Temperature range between -5°C and +40°C.
- <> Avoid direct exposure to heat and UV rays.
- <> Products from Smooth Line series are intended for indoor use responding to the above.
- <> The installation must be done by qualified personnel in accordance with equipment standards.

.....

.....

.....

.....

.....

.....

COMMANDS FOR HOME AUTOMATION:
SINGLE COMMANDS FOR BUS SYSTEM
XR1401 - XR1404 - XR1411

COMMANDS FOR HOME AUTOMATION:
DOUBLE COMMANDS FOR BUS SYSTEM
XR1402 - XR1403 - XR1405

COMMANDS FOR HOME AUTOMATION:
SINGLE COMMANDS FOR BUS SYSTEM
XR1401 - XR1404 - XR1411

COMMANDS FOR HOME AUTOMATION:
DOUBLE COMMANDS FOR BUS SYSTEM
XR1402 - XR1403 - XR1405

COMMANDS FOR HOME AUTOMATION

Front / Side / Rear Views - Dimensions (mm)

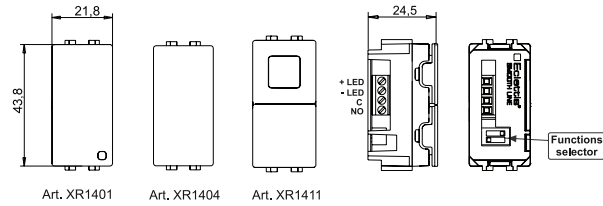

Front / Side / Rear Views - Dimensions (mm)

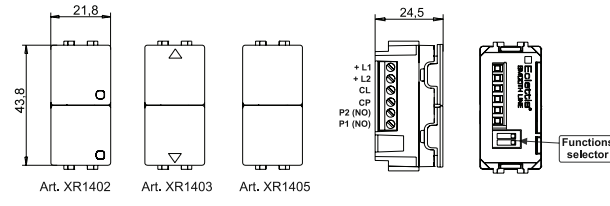

Functions selector:

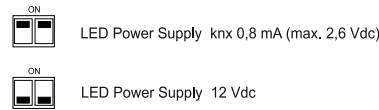

Before powering the LED make sure you have configured correctly the selector

Functions selector:

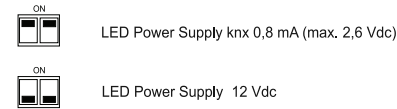

Before powering the LED make sure you have configured correctly the selector

Wiring diagrams:

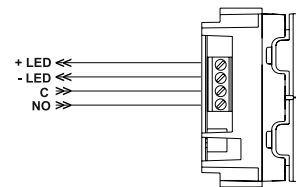

Wiring diagrams:

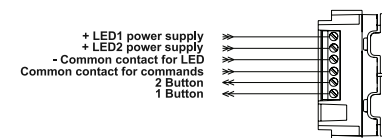

.....

.....

.....

Technical data:

- <> contacts: 1 impulsive (C - NO) - 50mA 12Vcc max
- <> possible selection:
 - > LED power supply: 2,6 / 12 Vdc

Warnings:

- <> Store in a dry place at temperature between -5°C and +40°C.
- <> Handle with care. To be transported in a dry and dusty environment at a temperature between -5°C and +40°C
- <> Temperature range between -5°C and +40°C.
- <> Avoid direct exposure to heat and UV rays.
- <> Products from Smooth Line series are intended for indoor use responding to the above.
- <> The installation must be done by qualified personnel in accordance with equipment standards.
- <> Before connecting the device, ensure that the working voltage is properly configured. The use of incorrect voltage can damage the device.

Technical data:

- <> contacts: 2 impulsive (C - NO) - 50mA 12Vcc max
- <> possible selection:
 - > LED power supply: 2,6 / 12 Vdc

Warnings:

- <> Store in a dry place at temperature between -5°C and +40°C.
- <> Handle with care. To be transported in a dry and dusty environment at a temperature between -5°C and +40°C
- <> Temperature range between -5°C and +40°C.
- <> Avoid direct exposure to heat and UV rays.
- <> Products from Smooth Line series are intended for indoor use responding to the above.
- <> The installation must be done by qualified personnel in accordance with equipment standards.
- <> Before connecting the device, ensure that the working voltage is properly configured. The use of incorrect voltage can damage the device.

.....

.....

.....

Eclettis is a brand of
▶ **FIN.OWNER**
info@eclettis.com
eclettis.com

via Rosciano, 1a
60030 Belvedere Ostrense (An) Italia
t. 0039 0731 217038
f. 0039 0731 217039